

TCC-6000 LAMINATOR PARTS MANUAL

DRAWING NO	PART NO	DESCRIPTION	DRAWING NO	PART NO	DESCRIPTION
001	3H1-B1	CONTROL PANEL	024-1	3H2-D14-2	HOOK PLATE (MIDDLE)
001-1	3H1-B1-1	AL PLATE	025	3H1-D15A	MOTOR RACK
002	3LM-B3	BUSH	026	3H1-D16	SWITCH RACK
003	3H1-B5	FRONT ROLLER (UPPER)	027	3H1-D17	HEAT-RESIST PLATE
003-1	3H1-B5A	MIDDLE ROLLER (UPPER)	028	3H2-D19	CHAIN GEAR
004	3H1-B6	FRONT ROLLER (LOWER)	029	3H2-D19-1	CHAIN GEAR
004-1	3H1-B6A	MIDDLE ROLLER (LOWER)	030	3H2-D19-2	CHAIN GEAR
005	3H1-B7	REAR ROLLER (LOWER)	031	3H2-D20	RACK
006	3H1-B8	REAR ROLLER (UPPER)	031-1	3H2-D21	RACK
007	B-9	FOOT PAD	032	3H1-D21	SMALL GEAR
008	3H2-D1	BASE BOARD	033	3H1-D22	BIG GEAR
009	3H1-D4	TOP COVER	034	3LM-D24	SPRING
017	3H1-D9	REAR PLATE	035	3H1-D27	FIXED PLATE
018	3H1-D10	PRESSURE PLATE	036	3H1-D28	Cu BUSH
019	3H2-D11A	BRACKET<LEFT>	037	3H1-D29	BUSH
020	3H2-D12	BRACKET<RIGHT>	038	3H1-D30	THERMO SET
021	3H1-D13	HOOK PLATE (BACK)	039	3H1-D31	PANEL RACK
022	3H1-D13-1	HOOK PLATE (FRONT)	040	3H1-D32	FAN RACK
022-1	3H2-D13-2	HOOK PLATE (MIDDLE)	041	3H1-D33	THERMO PLATE
023	3H1-D14	HOOK PLATE (BACK)	042	3H1-D34	CHAIN
024	3H1-D14-1	HOOK PLATE (FRONT)	042-1	3H1-D34-1	CHAIN

TCC-6000 LAMINATOR

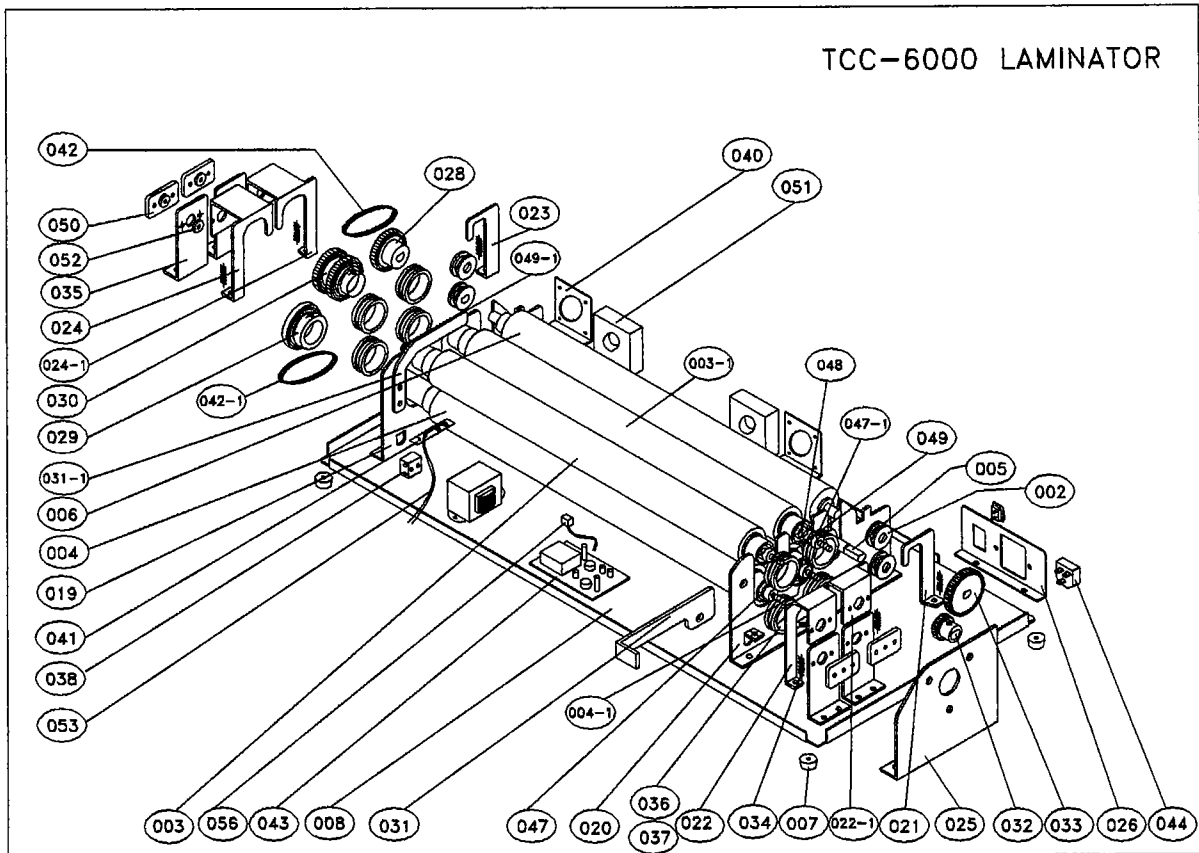

TCC-6000 LAMINATOR

