

TCC-210EPB COMBO

DRAWING NO.	PART NO.	DESCRIPTION	DRAWING NO.	PART NO.	DESCRIPTION
101	B-4	KNOB (RIGHT)	127	D-8T	PLATE
102	B-5	WEDGE	128	D-9T	TRANSMISSION PLATE
103	B-9	RUBBER FOOT	129	D-10T	CARRIER
104	C-2	MARK PLATE	130	D-11N	CRANK
106	CA-1TA	BASE BOARD	131	D-12T	SWITCH PLATE
108	CB-1	DRAWER	132	D-19T	SWING PLATE
109	CB-3	PAPER STOP SCREW	133	D-35A	SPRING
110	CB-4	PAPER STOP GUIDE	134	D-38T	MOTOR FIXED PLATE (REAR)
111	CB-5	PAPER STOP NUT	135	D-39T	SHAFT
112	CB-21	ALIGNMENT SCALE	136	DY-2T	COVER PLATE(LEFT)
113	CB2-D7A	PAPER GUIDE PLATE	138	DY-3T	COVER PLATE(RIGHT)
114	CB5-D6A	TRANSMISSION PLATE (LEFT)	140	FD-13A	TOOTH SEGMENT
115	CB5-D6A1	TRANSMISSION PLATE (RIGHT)	141	FD-32	W TYPE SPRING
116	CB5-D10TA	AXLE	142	FD-38	BUSH
117	CB5-D10TB	SUB-AXLE	143	TB-5	PLASTIC HOLDER
118	CB5-D18T	MOTOR FIXED PLATE (FRONT)	144	TB-8	BUSH
119	CB5-D36A	SUPPORT POLE	145	TB-11	AXLE CAP
120	NH-D6A	BRACKET	146	TC-8	CARRIER
121	CD-25A	PAPER STOP RAIL COMPLET	147	TC-14-2	HANDLE
123	D-1T	BACK COVER	148	TC-16	SLIDE
124	D-2TA	FORNT COVER	149	NH-B1	ADJUSTMENT PLATE
125	D-3	COVER PLATE	150	NH-B2	SET-PIN GUIDER
126	D-7T	RAKE	151	NH-B2A	SET-PIN GUIDER

TCC-210EPB COMBO

DRAWING NO.	PART NO.	DESCRIPTION	DRAWING NO.	PART NO.	DESCRIPTION
152	NH-D3A	STOP GUIDE AXLE			
153	NH-D4B	GUIDE PLATE			
154	NH-D8B	SET PIN			
155	NH-D10A	BEARING BRACKET (LEFT)			
156	NH-D11A	BEARING BRACKET (RIGHT)			
157	NH-D15B	RACK			
161	NH-KB	KNIFE SET			
163	3LM-B4-1	GEAR			
164	EP-15	P.C.B			
165	EP-15-1	COIL			
166	SP-1T	MOTOR			
167	SP-1T-1	CONDENSER			
168	SP-2A	OPTICAL S.W			
170	SP-1	POWER S.W			
171	SP-2T	SOCKET			
172	SP-3	BUTTON S.W			
173	D312TCC210EPB	BEARNING			
174	CB-11	SPACER			
175	CB-12	SPACER			
178		SCREW			

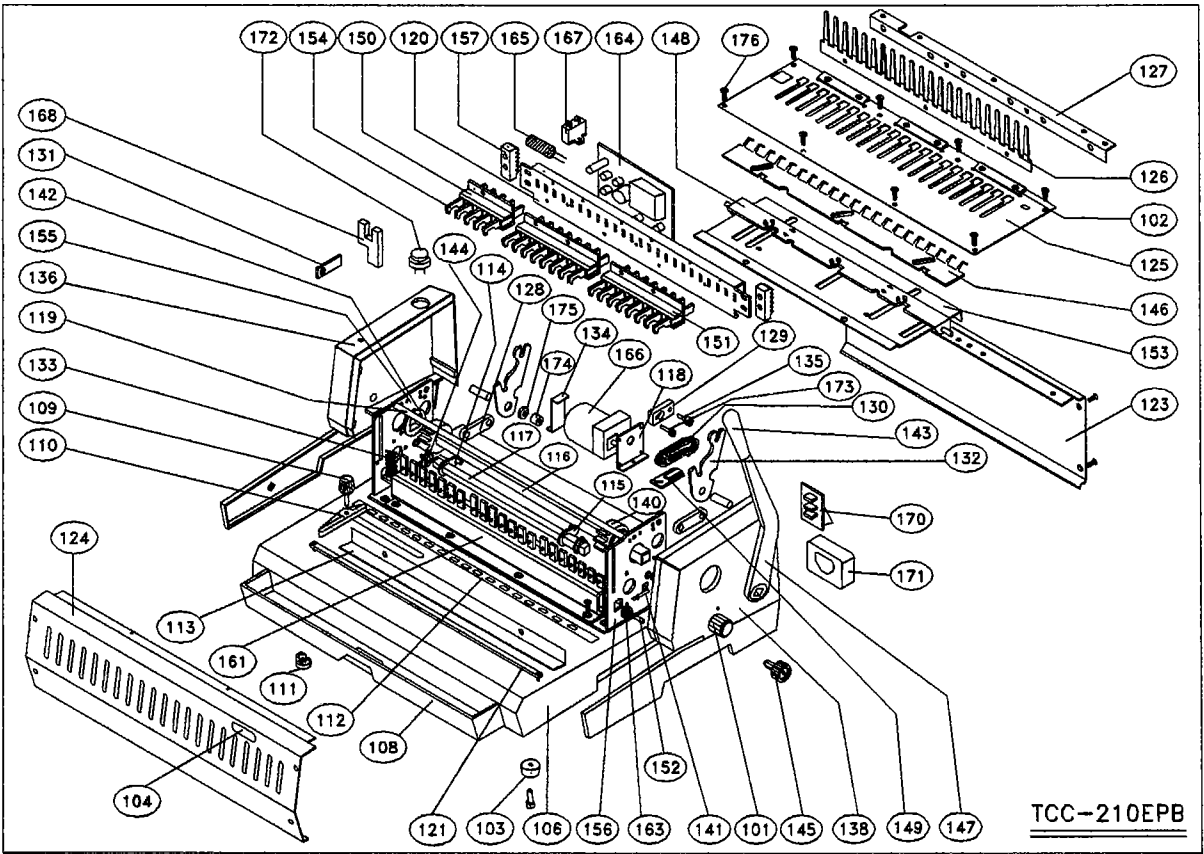

TCC-210EPB